

A-A
1:2

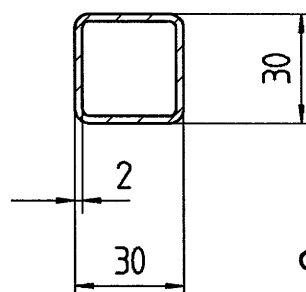

- 6 -02- 2018

ARCHIV

1

LM/18/00036

03 DIN 50979 - ZnFe12/Fn/IT2

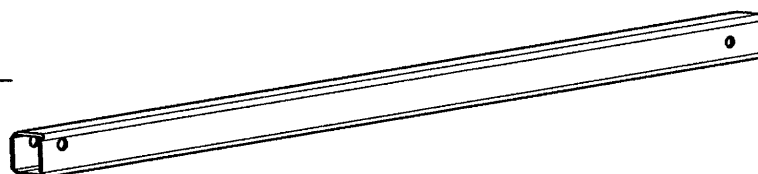

First angle projection		03 change the coatings to Cr(VI)-free coatings		T92692															
		<i>ZMENA POVRCHOVE ÚPRAVY</i>																	
General tolerance (GT) in mm		Index		alteration		Change no													
Size range						Fit													
						Toler.													
<table border="1"> <tr> <td>≤ 30</td> <td>> 30 ≤ 120</td> <td>> 120 ≤ 400</td> <td>> 400 ≤ 1000</td> </tr> <tr> <td>1</td> <td>2</td> <td>3</td> <td>4</td> </tr> </table>		≤ 30	> 30 ≤ 120	> 120 ≤ 400	> 400 ≤ 1000	1	2	3	4	PPAP -		Material: Hohlprofil DIN 59410-S355JO-30		Weight: in kg					
≤ 30	> 30 ≤ 120	> 120 ≤ 400	> 400 ≤ 1000																
1	2	3	4																
		Inspection dim. <input type="radio"/> Aux.dim. ()		Blank no:		1.148													
GT coarse		Date		Name		Title:													
<table border="1"> <tr> <td>L</td> <td>1</td> <td>2</td> <td>2</td> <td>3</td> <td>4</td> </tr> <tr> <td>Δ</td> <td>1</td> <td>2</td> <td>4</td> <td>6</td> <td></td> </tr> </table>		L	1	2	2	3	4	Δ	1	2	4	6		Drawn 07.04.2017				rod	
L	1	2	2	3	4														
Δ	1	2	4	6															
Lengths (L) and angle (∠) = ±GT		Checked 23.06.2017				Prod.													
		Auth'd 20.07.2017				Scale													
		M.check. 24.07.2017				1:5													
Tolerance Symbols ISO 1101						Sheet:													
○ roundness = 1/2⌀-Tol. —□ straightness/flatness = AT ⊙ concentricity/run out = AT symmetry = AT // parallelism = AT ⊕ position = AT						of: 1													
Languages: DE;EN		Confidential document		Repl.		Orig.													
		Refer to protection notice ISO 16016																	

Released

1013977/D2D/001/03

A4

55044233400 DE7CA7 2017-12-12T08:47:59 1.000
55044233400 DE7CA7 2017-12-12T08:47:59 1.000
55044233400 DE7CA7 2017-12-12T08:47:59 1.000